

Clamex P Medius 14/10

Pat. pend.

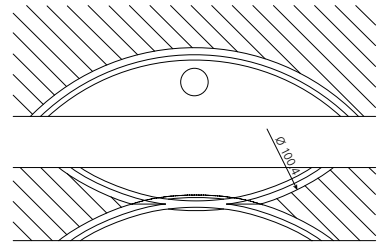
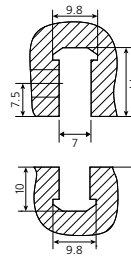
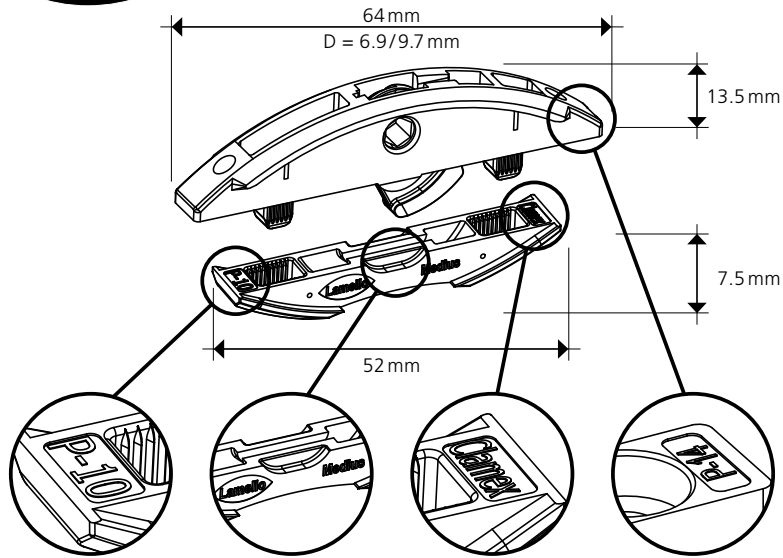

Zugbruchfestigkeit/ Tensile strength:

- Spanplatte/Particle board:
~ 600 N = 60 kg
- Buche massiv/Beech massive:
~ 800 N = 80 kg
- MDF:
~ 800 N = 80 kg

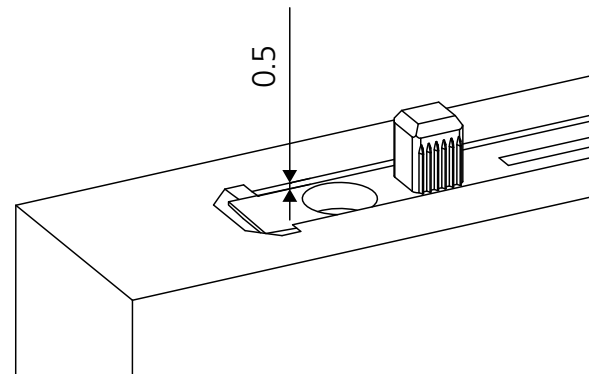
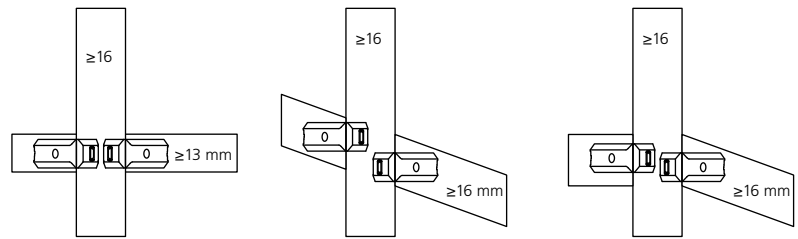
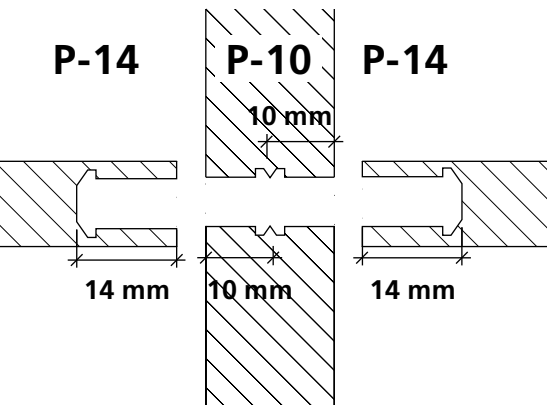
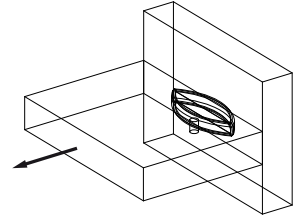

Scharfe Fräser verwenden
Use sharp cutters

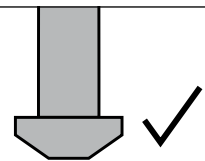
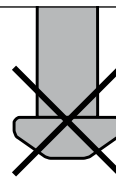

Divario P-18



Paar/Pair/ Paire/Paio	Art. No.
80	145550
300	145560
1000	145570

Tenso P-14



Paar/Pair/ Paire/Paio	Art. No.
80	145415
300	145425
1000	145435

Clamex P Medius 14/10



Paar/Pair/ Paire/Paio	Art. No.
80	145370
300	145371

Clamex P-14



Paar/Pair/ Paire/Paio	Art. No.
80	145334
300	145346
1000	145356

Clamex P-10



Paar/Pair/ Paire/Paio	Art. No.
80	145372
300	145373
1000	145374

Bisco P-14 Bisco P-10



Stück/Piece/ Pièce/Pezzi	Art. No.
P-10 80	145304
300	145305
P-14 80	145301
300	145302
1000	145303

Zeta P2

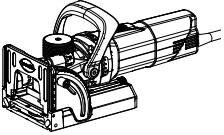

Art.No. 101402

P-14

P-10

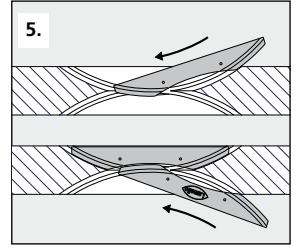
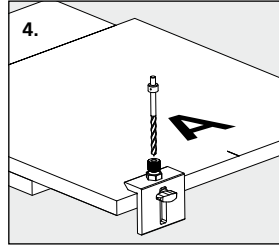
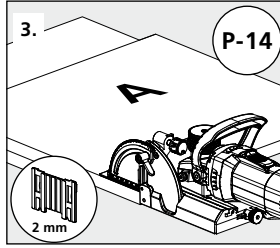
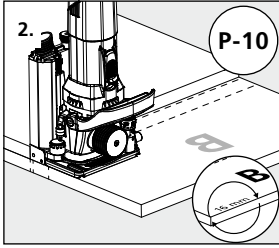
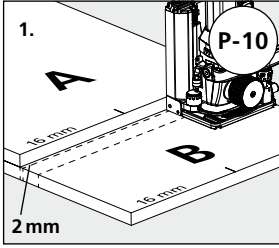
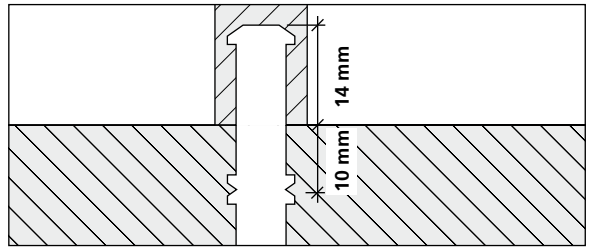
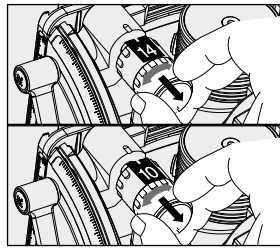



Art.No. 132140 (Diamant)
DP, Ø 100.4 x 7 x 22 mm



Art.No. 132141
HW, Ø 100.9 x 7 x 22 mm



Art. No. 131506
Ø = 6 mm



Art.No. 125344

CNC | Partner network: www.lamello.com

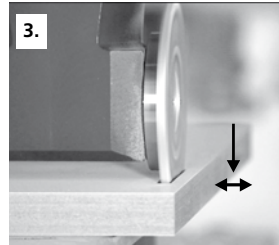
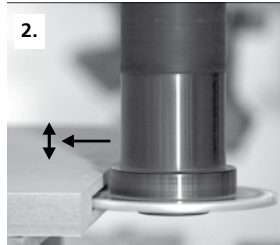
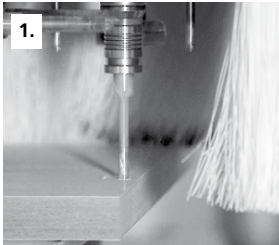
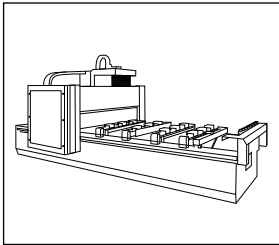

Art. No. 132142
DP, 100.4 x 7 x 30 mm
4 / 6.6 / DTK 48 mm
* Passend zu allen aufgeführten Fräsdornen
Suitable for all cutter arbors listed

Art. No. 132143
DP, 100.4 x 7 x 40 mm
4 / 5.5 / DTK 52 mm

Art. No. 132144
DP, 100.4 x 7 x 16 mm
4 / 5.5 / DTK 28 mm



* **Art. No. 132150**
20 x 50, L = 102 mm

* **Art. No. 132151**
25 x 60, L = 102 mm

* **Art. No. 132152**
16 x 50, L = 85 mm

* **Art. No. 132153**
16 x 55, L = 68 mm

* **Art. No. 132154**
16 x 50, L = 85 mm, mit Spannfläche (2°-schräg)/with clamping surface (2°-angle)

* **Art. No. 132155**
20 x 50, L = 85 mm, mit Spannfläche (2°-schräg)/with clamping surface (2°-angle)



Abdeckkappen / Cover caps
100 Stück / 100 Pieces

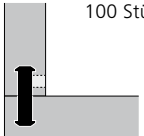

90°

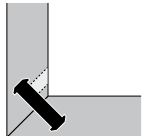

45°

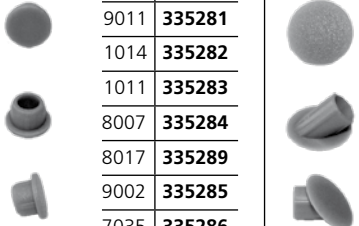

RAL	Art. No.	RAL	Art. No.
9010	335280	9010	335380
9011	335281	9011	335381
1014	335282	1014	335382
1011	335283	1011	335383
8007	335284	8017	335384
8017	335289	7022	335388
9002	335285		
7035	335286		
7040	335287		
7031	335288		

Art. No. 131556
Ø = 6 / 10 mm
l = 100 / 35 mm



Art. No. 271945
Ø = 4 mm
75 x 55 mm

Art. No. 271945A
Ø = 4 mm
120 x 50 mm



Art. No. 251993
Ø = 4 mm
flexibel

