

a1:	18,0 mm
a2:	21,0 mm
b1:	200,0 mm
b2:	168,0 mm
b3:	173,0 mm
c1:	21,0 mm
c2:	22,0 mm
c3:	24,0 mm
c4:	25,0 mm

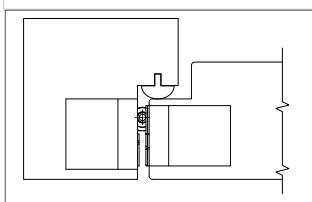

Applicazione legno massiccio

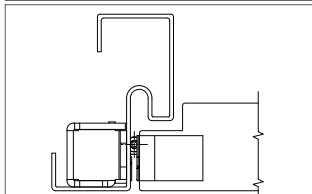

Applicazione telaio in acciaio

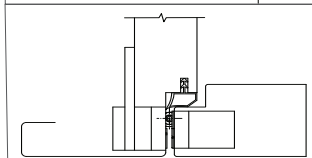

Applicazione telaio ricoperto

Tipo di materiale: Zama

Finitura

Zincato GSS
Spessore di zinco
min. 5 micron

Test secondo normativa RAL

Portata con 2 cerniere

50 Kg.

Product Management:

Firma:

Data 30.09.2016