

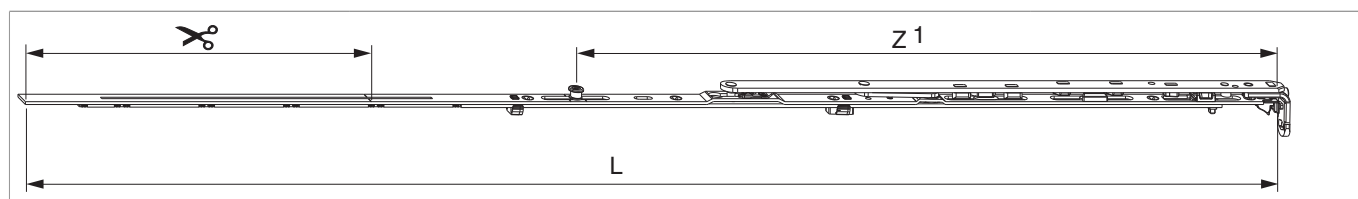







212081 - Forbice ad angolo premontata MM per R-A 1050 LBB 801-1.050 con 1 fungo argento

Disegni tecnici



						L		Nº
argento	Forbice ad angolo premon- tata MM	1050	801 - 1.050		260	946,5	10	212081 ¹⁾

¹⁾ Con LBB oltre 1301 mm usare tassativamente la forbice supplementare.

Tabella posizionamento viti

Nº		1	2	3	4	5	6	
212081	5	18,5	91,5	333	452	564		

Tabella punti di chiusura

Nº		Z1	
212081	1	528	

Schema di tranciatura

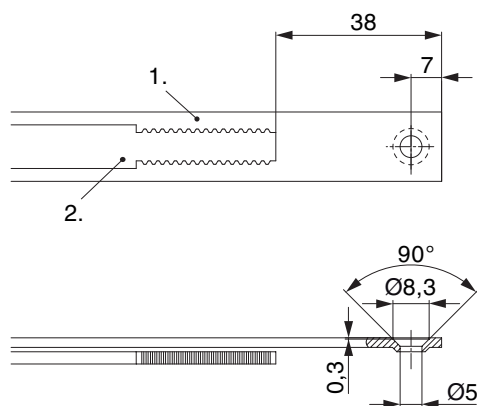

• Consigliamo di trattare il taglio dei componenti TRICOAT-PLUS con la vernice di ritocco TRICOAT-PLUS (cod. 358440).

- 1. Frontale
- 2. Asta mobile

Collegamento a clips

Aggiungere collegamenta a clips

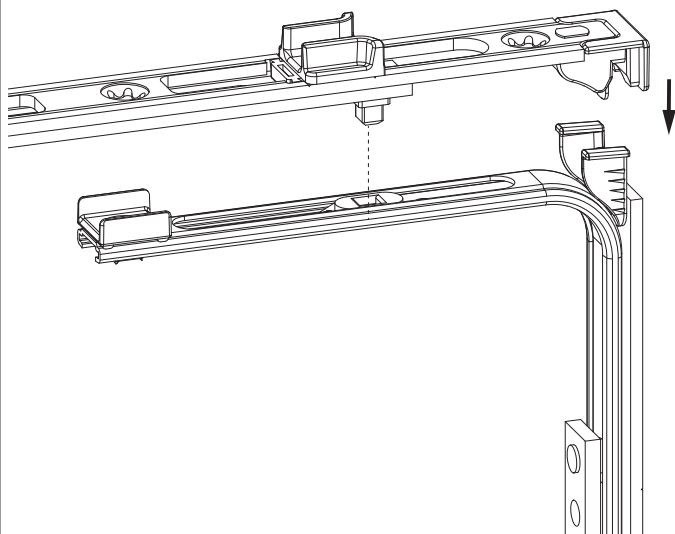

Sganciare collegamento clips

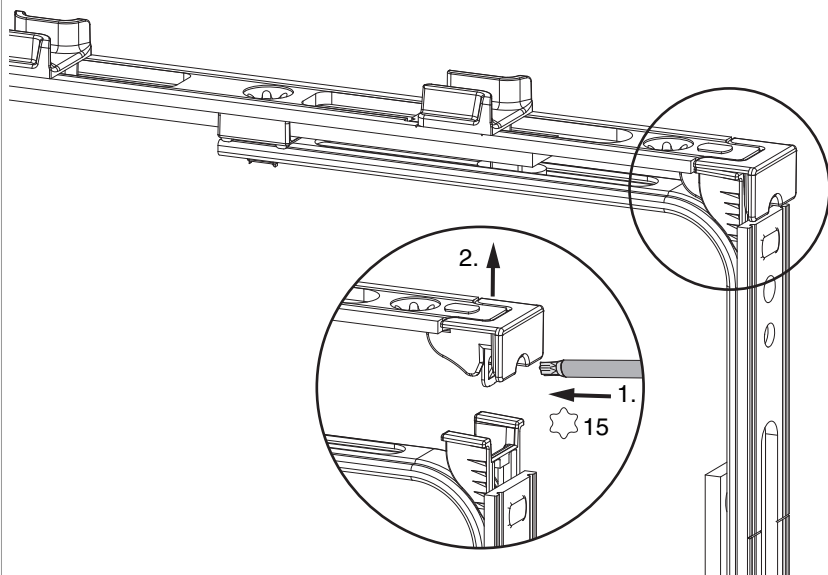

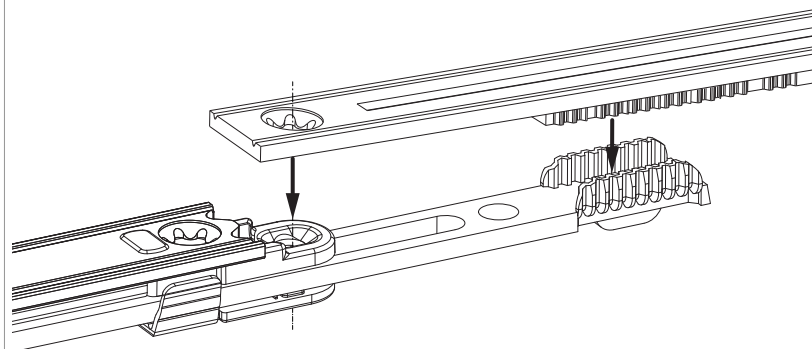

Collegamento scarpetta dentata

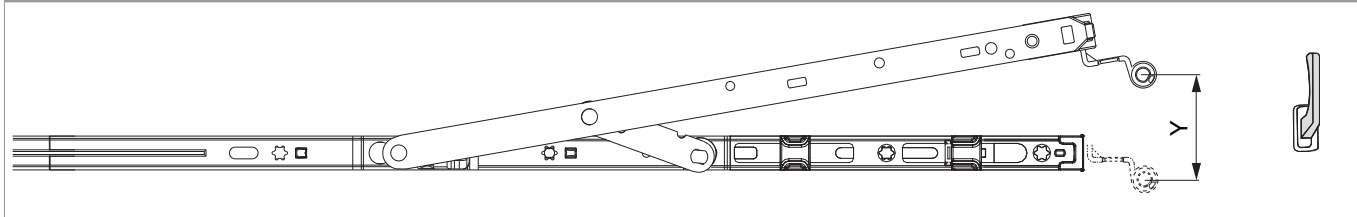

Raggio di apertura

Posizione a ribalta



	Y
400	120
600	125
800	125
1050	127
1300	127

Regolazione laterale

nel braccio forbice

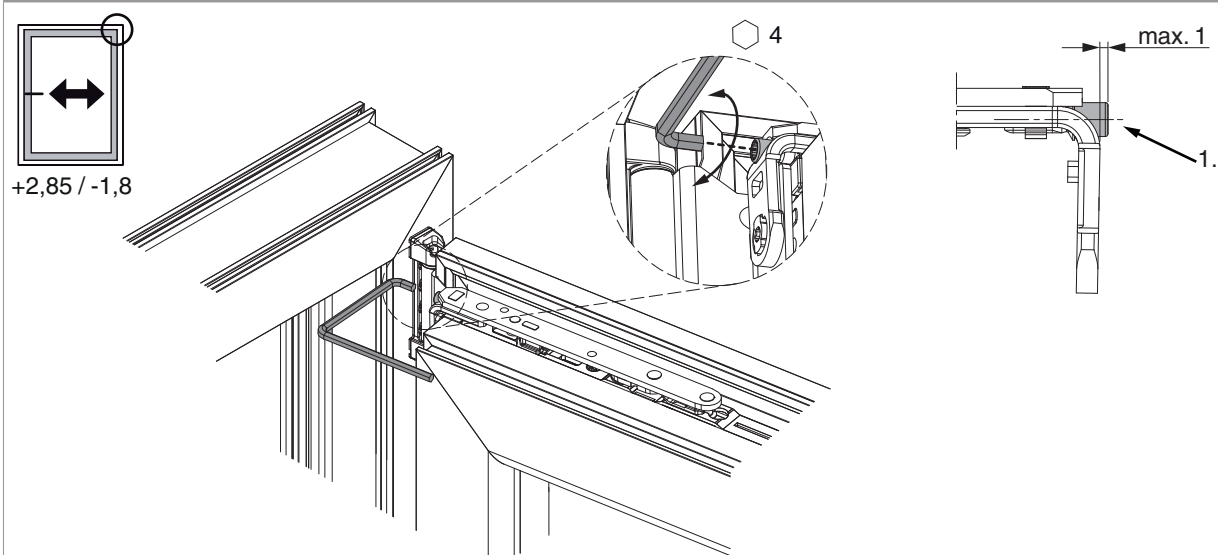

1. Durante l'abbassamento dell'anta assicurarsi che la vite non fuoriesca completamente. La testa della vite deve sporgere al massimo 1 mm!

Regolazione pressione

nel braccio forbice

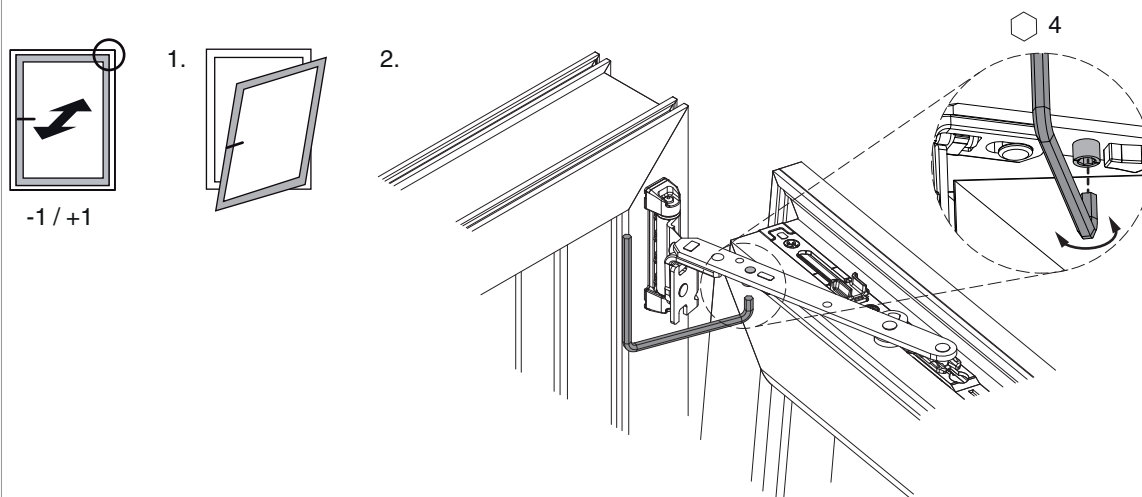

Fungo e nottolino

