

Descrizione Description	Articolo Product code	Finiture Finishes					Misure mm Measures mm											Packaging			Note
		IN	IT	IF	XP	X6	A	A2	B	C	Ø	D	E	F	G	H	U.M.	Pack	Kg		
Serie / Series SMERALDA																					
Modello / Model Catenaccio finale tondo																					
Round end locking bolt	cm 20	FCS 00659 N3	●	●				150	45	45	40	18	8	20				pcs	5	2,0	
	HINOX	cm 20	FCS 00658 N3	●	●	●	●	150	45	45	40	18	8	20				pcs	5	2,0	
	cm 30	FCS 00659 N5	●	●				250	45	45	40	18	8	20				pcs	5	3,0	
	HINOX	cm 30	FCS 00658 N5	●	●	●	●	250	45	45	40	18	8	20				pcs	5	3,0	
	cm 40	FCS 00659 N7	●	●				340	50	45	40	18	8	20				pcs	5	3,9	
	HINOX	cm 40	FCS 00658 N7	●	●	●	●	340	50	45	40	18	8	20				pcs	5	3,9	
	cm 50	FCS 00659 N8	●	●				440	52	45	40	18	8	20				pcs	5	4,9	
Serie / Series BRAIT																					
Modello / Model Catenaccio finale tondo																					
Round end locking bolt	cm 20	FCS 00659 N3			●			150	45	45	40	18	8	20				pcs	5	2,0	
	cm 30	FCS 00659 N5			●			250	45	45	40	18	8	20				pcs	5	3,0	
	cm 40	FCS 00659 N7			●			340	50	45	40	18	8	20				pcs	5	3,9	
	cm 50	FCS 00659 N8			●			440	52	45	40	18	8	20				pcs	5	4,9	
Serie / Series BAITA																					
Modello / Model Catenaccio finale tondo																					
Round end locking bolt	cm 30	FCS 00060 N5	●					255	55	50	40	18	10	25				pcs	2	2,1	
	cm 50	FCS 00060 N8	●					455	55	50	40	18	10	25				pcs	2	3,5	
Serie / Series SMERALDA																					
Modello / Model Catenaccio leggero finale tondo																					
Light weight round end locking bolt	cm 10	FCS 00659 L1	●	●				80	25	33	31	14	6	14				pcs	12	1,4	
	cm 15	FCS 00659 L2	●	●				126	35	33	31	14	6	14				pcs	12	1,9	
	cm 25	FCS 00659 L4	●	●				197	46	33	31	14	6	14				pcs	12	3,0	
	cm 40	FCS 00659 L7	●	●				339	45	33	31	14	6	14				pcs	12	3,9	
Serie / Series BRAIT																					
Modello / Model Catenaccio leggero finale tondo																					
Light weight round end locking bolt	cm 10	FCS 00659 L1			●			80	25	33	31	14	6	14				pcs	12	1,4	
	cm 15	FCS00659 L2			●			126	35	33	31	14	6	14				pcs	12	1,9	

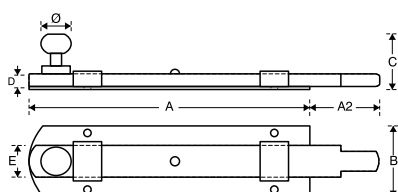
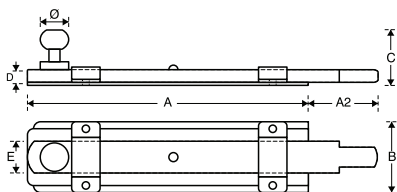

- IN** ferro fondo zincato e copertura polveri poliesteri nero RAL 9005
zinc treatment iron black powder coating
- IT** ferro tropicalizzato
yellow zinc iron
- IF** ferro fondo zincato e copertura polveri poliesteri finitura Brait
"Brait" finish iron
- XP** acciaio inox verniciato nero RAL 9005
stainless steel black painted RAL 9005
- X6** acciaio inox verniciato trasparente
stainless steel transparent paint

SMERALDA

Modello
Catenaccio finale tondo

Model
Round end locking bolt

Dimensioni /
Dimensions available
cm 20
cm 30
cm 40
cm 50

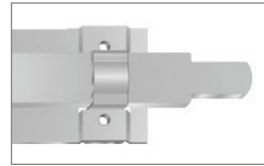
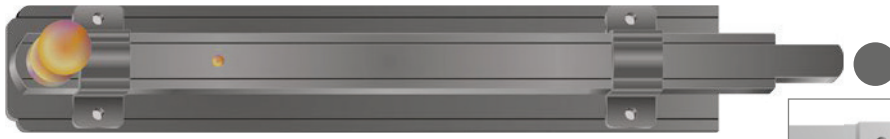

X6
Acciaio inox verniciato trasparente
Stainless steel transparent paint

BRAIT

Modello
Catenaccio finale tondo

Model
Round end locking bolt

Dimensioni /
Dimensions available
cm 20
cm 30
cm 40
cm 50



BAITA

Modello
Catenaccio finale tondo

Model
Round end locking bolt

Dimensioni /
Dimensions available
cm 30
cm 50



Bandelle relative alla serie di prodotto a pag.94-97
Series related hinges to the product line at pages 94-97
Cerniere relative alla serie di prodotto a pag.100-101
Series related hinges to the product line at pages 100-101

SMERALDA

Modello
Catenaccio finale tondo leggero

Model
Light weight round end locking bolt

Dimensioni /
Dimensions available
cm 10
cm 15
cm 25
cm 40



BRAIT

Modello
Catenaccio finale tondo leggero

Model
Light weight round end locking bolt

Dimensioni /
Dimensions available
cm 10
cm 15

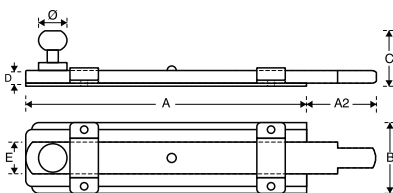

Per un'applicazione a regola d'arte, tutti i catenacci finale tondo vanno utilizzati con il relativo pozzetto antipolvere (vedi pag.134-135)
For a well made application, all round end locking bolts must be applied with related antidust pit (see page 134-135)